

SIDE ELEVATION

FRONT ELEVATION

REAR ELEVATION

SIDE ELEVATION

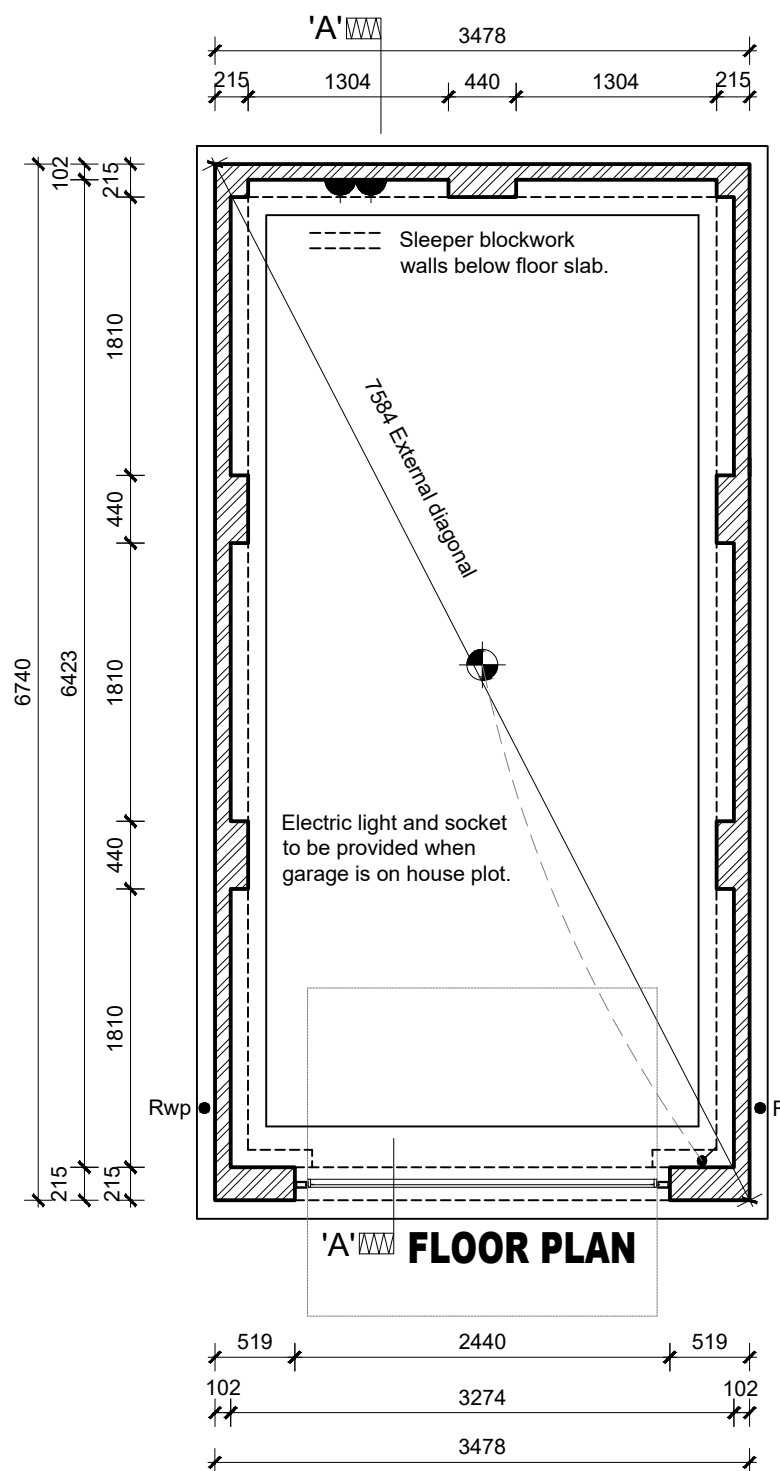

'A-A' FLOOR PLAN

SUSPENDED SLAB OPTION SHOWN. REFER TO SEPARATE DRAWING FOR B&B OPTION.

FOUNDATIONS / GROUND FLOOR SLAB

Foundation widths / type are indicative only. Refer to Structural Engineers' Foundation and Suspended Slab Design for detailed information.

For plot specific Foundation / Slab Design refer to Site Structural Engineers' information.

Depth of foundation to satisfy NHBC requirements and to be agreed on site with approved inspector.

Solid brick internal piers to continue up the full height of the wall. Ancon SPS CJ wall ties (or similar approved) staggered @ 450mm c/s vertically to tie piers to external brickwork. Lateral restraint straps to be provided at ceiling and roof level to tie in with these pier locations.

RWP positions may differ from that shown. For actual location refer to site specific drainage layout

7'6" x 7'2" (2286x2200) with retractable gear. Frames to be fitted within opening.

O/A frame width = 2286 + 140 = 2426

O/A frame height = 2200 + 45 = 2245

WALL KEY:

- Facing Brickwork (Ext Walls - Ext Leaf)
- Lightweight Aggregate Blockwork to medium density 1350kg/m3 – 1600kg/m3 (Above lintel)

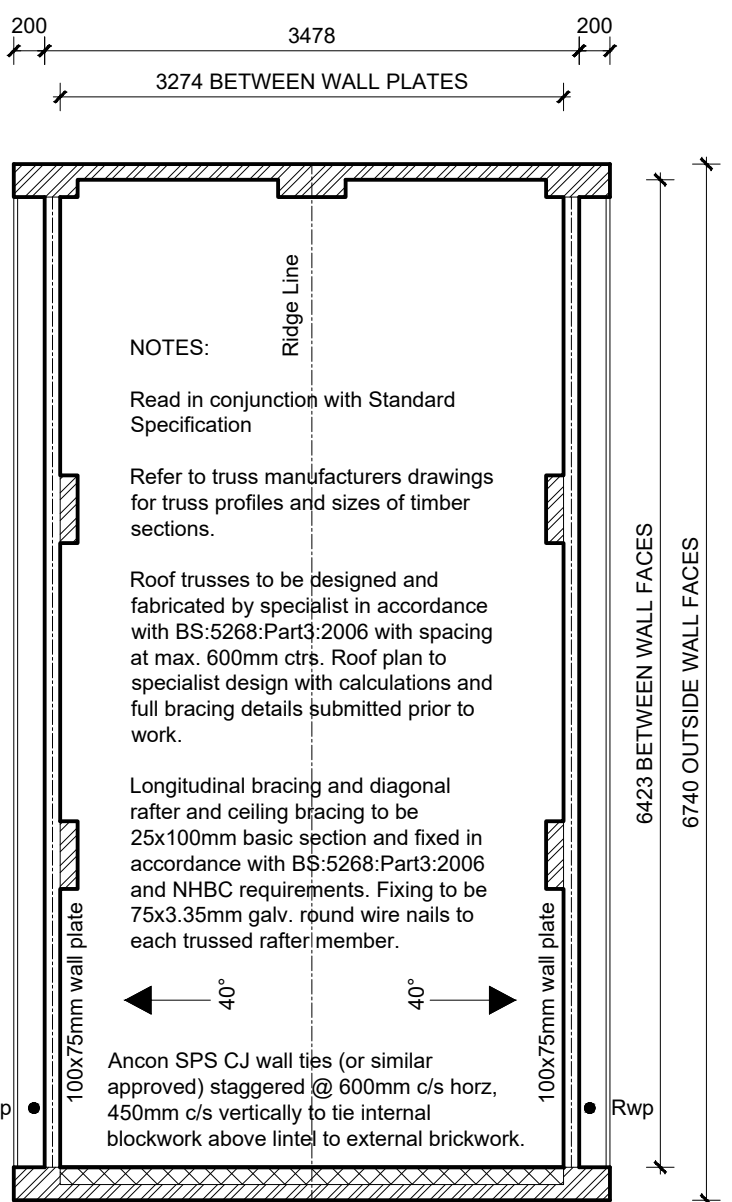

I.G LINTEL - L9 MEDIUM DUTY 2700 (2250mm from DPC) over opening.

ROOF PLAN

NOTES:

Read in conjunction with Standard Specification

Refer to truss manufacturers drawings for truss profiles and sizes of timber sections.

Roof trusses to be designed and fabricated by specialist in accordance with BS:5268:Part3:2006 with spacing at max. 600mm ctrs. Roof plan to specialist design with calculations and full bracing details submitted prior to work.

Longitudinal bracing and diagonal rafter and ceiling bracing to be 25x100mm basic section and fixed in accordance with BS:5268:Part3:2006 and NHBC requirements. Fixing to be 75x3.35mm galv. round wire nails to each trussed rafter member.

Ancon SPS CJ wall ties (or similar approved) staggered @ 600mm c/s horz, 450mm c/s vertically to tie internal blockwork above lintel to external brickwork.

GTO - BOQ REF : GL6D SDFG
2017 SINGLE DET FRONT GABLE

WORKING DRAWING

Date: _____
Description: _____
Rev: _____

WARNING TO HOUSE PURCHASERS - Property Misdescriptions Act 1991
Buyers are warned that this is a working drawing and the contents of this drawing may be subject to change at any time and alterations and variations can occur during the progress of the build process. As such the layout, form, content and dimensions of the finished construction may differ materially from those shown. Whilst we make every effort to ensure our drawings are up to date there may be changes in regulations and/or re-planning. Purchasers are advised to check with the Sales Adviser whether any alterations have been made to this drawing. The contents of this drawing do not constitute a contract, part of any contract or warranty.

Garage Type: **LSG1F7**
2017 SINGLE DET FRONT GABLE (6 x 3m)
Scale: 1:50 / 1:100
Drawn: **GDT** Checked: **GDT** Date: **Nov 17**

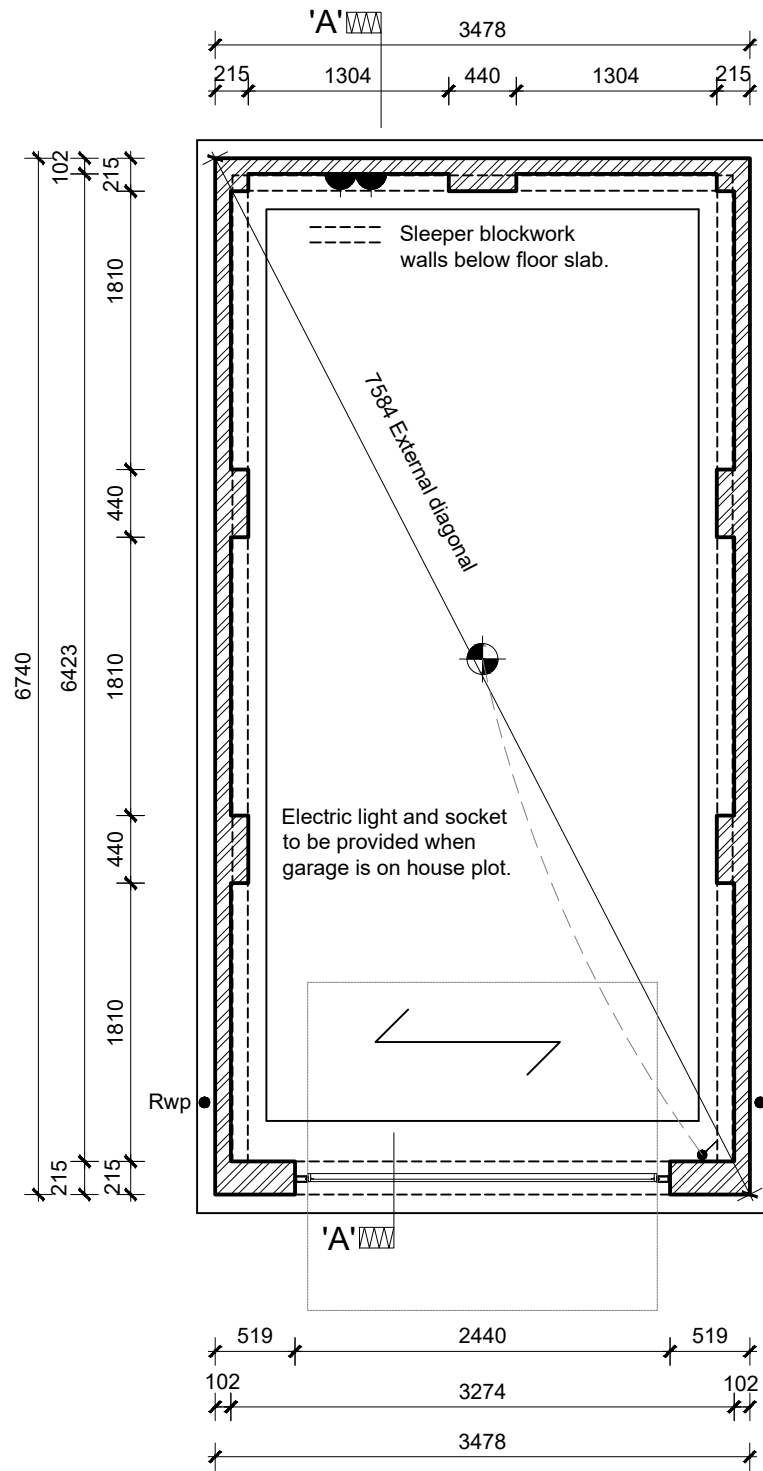

BEAM AND BLOCK - FLOOR PLAN

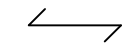

Denotes direction for B & B floor to span.

FOUNDATIONS / GROUND FLOOR SLAB

Foundation widths / type are indicative only. Refer to Structural Engineers' Foundation and Suspended Slab Design for detailed information.

For plot specific Foundation / Slab Design refer to Site Structural Engineers' information.

Depth of foundation to satisfy NHBC requirements and to be agreed on site with approved inspector.

Solid brick internal piers to continue up the full height of the wall. Ancon SPS CJ wall ties (or similar approved) staggered @ 450mm c/s vertically to tie piers to external brickwork. Lateral restraint straps to be provided at ceiling and roof level to tie in with these pier locations.

RWP positions may differ from that shown. For actual location refer to site specific drainage layout

7'6" x 7'2" (2286x2200) with retractable gear. Frames to be fitted within opening.

O/A frame width = 2286 + 140 = 2426

O/A frame height = 2200 + 45 = 2245

WALL KEY:

Facing Brickwork (Ext Walls - Ext Leaf)

GTO - BOQ REF : GL6D SDFG
2017 SINGLE DET FRONT GABLE

WORKING DRAWING	Date:
Rev:	Description:

WARNING TO HOUSE PURCHASERS - Property Misdescriptions Act 1991
Buyers are warned that this is a working drawing and the contents of this drawing may be subject to change at any time and alterations and variations can occur during the progress of the build process. As such the layout, form, content and dimensions of the finished construction may differ materially from those shown. Whilst we make every effort to ensure our drawings are up to date there may be changes in regulations and/or re-planning. Purchasers are advised to check with the Sales Adviser whether any alterations have been made to this drawing. The contents of this drawing do not constitute a contract, part of any contract or warranty.